

MONO

SELF PROPELLED
SEEDER
SPS

MONO

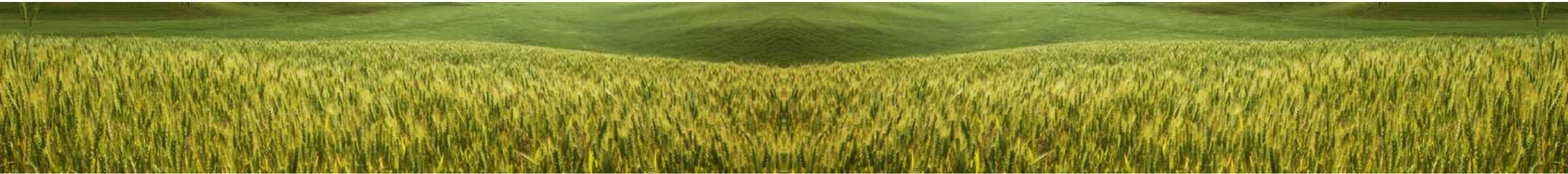



The importance of food safety and supply is increasing every passing day.

Seed Improvement works are the foremost in important elements for supplying more quality and cheaper foods to its own people by efficient use of Nation's lands.

MONO MAKİNE has started production of Improvement tools and equipment for development of domestic seeds without being dependent on foreign sources. Our company, operating at Ostim/ANKARA, has made huge progress in its subject area since the day it was founded and filled a large gap in the industry.

MONO MAKİNE continues to manufacture improvement tools and equipment in accordance with the recommendations and suggestions of people working in the field. Presents the state of the art possibilities with an innovative outlook by research to meet the needs of the industry. Planting Machinery, Threshing Machinery and Laboratory Machinery used in the seed improvement are MONO MAKİNE continues its R&D activities and manufactures manufactured completely by our company.

Tools and equipment in accordance with the requests of customers. Lowering the foreign dependence in the industry and ensuring the capital stays within borders is our most important value. Our aim is to become a worldwide recognized and industry-leading and followed manufacturer

MONO MAKİNA İTH. İHR. TİC. SAN. LTD. ŞTİ.



INDEX

CHASSIS
DISTRIBUTORS
OPENERS
ELECTRONIC SYSTEMS
OPTION LIST
TECHNICAL SPECIFICATIONS

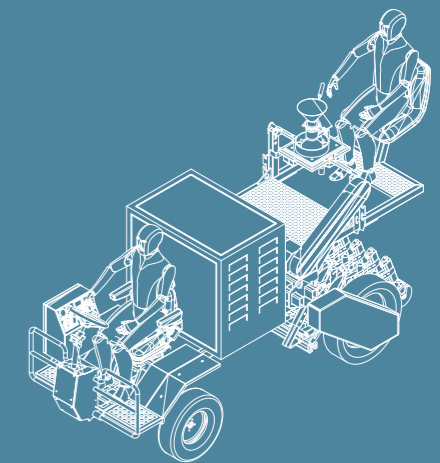

MONO

İvedik OSB Mahallesi 2265 Cad. No:30/32

Yenimahalle / ANKARA

☎ : +90 312 386 26 12

☎ : +90 312 386 26 13

🌐 : www.monomakine.com

✉ : info@monomakine.com

📺 : www.youtube.com/user/monomakine1

📘 : monomakine1

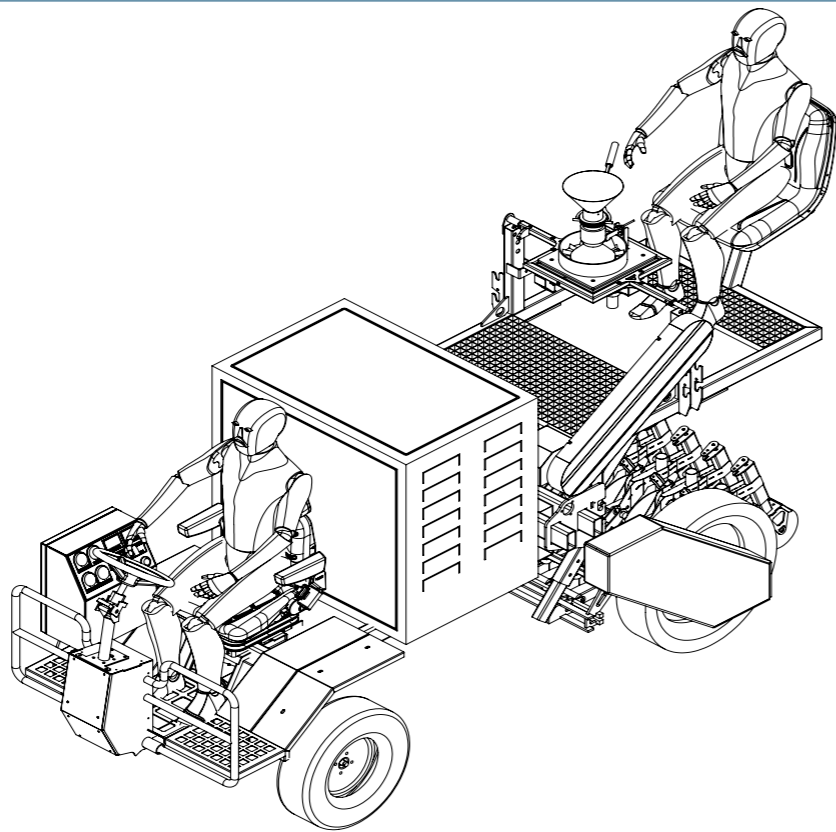

SPS

The seed planter is a machine specifically designed for seed breeding. It has been designed in consultation with seed developers and those working in the field of seed breeding to ensure the most efficient use. It is powered by a diesel engine, allowing for planting without the need for a tractor.

The MONO MAKINE Seed Planter can plant in 2, 4, 6, or 8 rows. Options can also be added for use with different crops. Electronic equipment can be added to improve ease of use and planting accuracy. Like all our machines, it is manufactured using high-quality equipment and spare parts to ensure many years of use.

Electronic equipment can be added to provide ease of use and increase the sensitivity of planting. Like all our machines, it is produced using high quality equipment and spare parts in order to be used for many years.

- The modern operator platform provides greater comfort.
- Longer service intervals reduce downtime.
- Suitable for many different crops.
- High maneuverability in confined spaces.
- Can be used for planting crops such as corn, sunflower, soybeans, etc. by adding a pneumatic system.
- Thanks to its modular structure, modifications can be made to the machine for different crops.

POWER TRAIN AND CHASSIS:

The machine is manufactured from steel sheet and profiles. It is equipped with a 21 kW Yanmar engine and a hydrostatic drive system. It can be operated steplessly between 0-15 km/h using a hydraulic joystick. Front and rear lighting systems are available for night work. All systems are produced modularly. All parts can be replaced later, or new parts can be ordered. The track width is adjustable. The lower carrier system is produced in 3 different lengths. Opening shoes can be combined in 2-4-6-8 configurations. Row spacing is adjustable. It can be adjusted steplessly between 14-30 cm in 6 rows and 14-70 cm in 4 rows. It is produced as standard with a single-person seat. An auxiliary operator seat can also be fitted upon request.

OPENER TYPES:

Shoe Opener: It is made of 10 mm material and the wear zone is hardened. Sowing is precisely adjusted up to 10 cm with plastic wheels at the rear.
 Double Disc Opener: It is produced with two angled discs of 33 cm in diameter. In addition, the wear zone is made of 10 mm sheet metal and the wear zone is hardened. Sowing is precisely adjusted up to 10 cm with plastic wheels at the rear.
 Fertilizer Opener: Used with fertilizer distributor.
 All openers can be ordered with hydraulic lift.





DISTRIBUTORS:

You can order the parcel seed drill with 4 different distributors. All distributors types can be used with automatic seeding system.

Mechanical Distributor: It is produced with a diameter of 275 mm as standard. It is suitable for plants with a seed size greater than 2 mm. It is produced from aluminum casting and coated with hard anodized. There is a 10-year warranty against wear. It is the most suitable distributor type for cereals because it does not require maintenance. Its parallelism to the ground plane can be adjusted laterally and vertically.

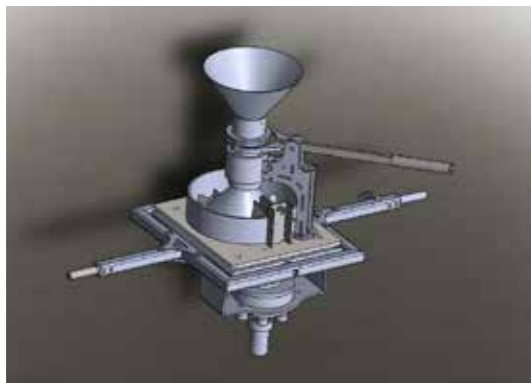

Belt Cone distributor: Made of aluminum solid material with a diameter of 225 mm. It is hard anodized. The seed conveyor belt is made of PVC material. Since it is suitable for all types of seeds, it is suitable for researchers working with different seeds. PVC tape needs to be maintained and replaced in fixed periods. Its parallelism to the ground plane can be adjusted laterally and vertically.

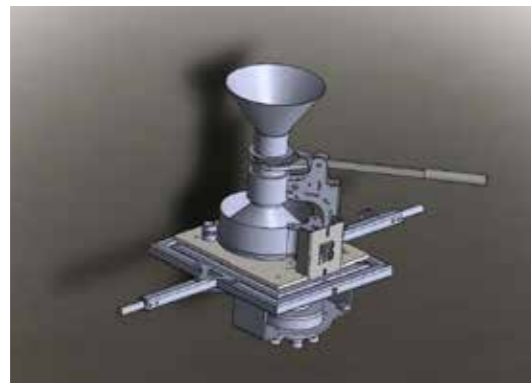

Double Distributor For Fertilizer And Seed: It is a system in which two distributors are mounted for fertilizer efficiency trials. It consists of two mechanical or Belt Cone distributors. Mechanical dispensers 275 mm in diameter, band dispensers are manufactured from aluminum with a diameter of 198 mm. It is hard anodized. Its parallelism to the ground plane can be adjusted laterally and vertically.

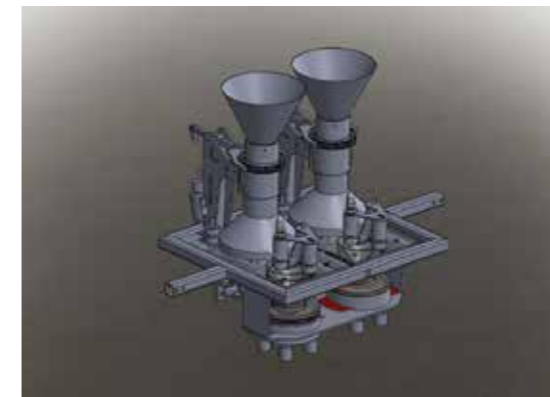

Multiple Distributor: It is used to sow different seeds in each row. It is made of 6 pieces of 110mm diameter solid aluminum material. It is used individually or with the magazine ear sowing system.

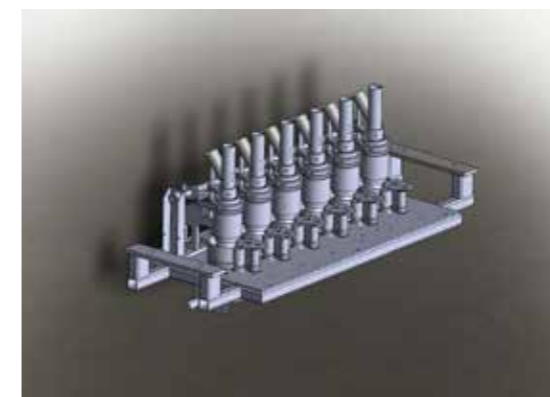



Automatic Magazine Ear Sowing: It is used to automatically sow 6 different seeds at the same time. It is used with multiple distributors and electronic control system. It is used with special 12 hole seed case and seed carrying plates made of 3 mm PVC. 1 carrier plate is required for every 10 piece special 12 hole seed case.

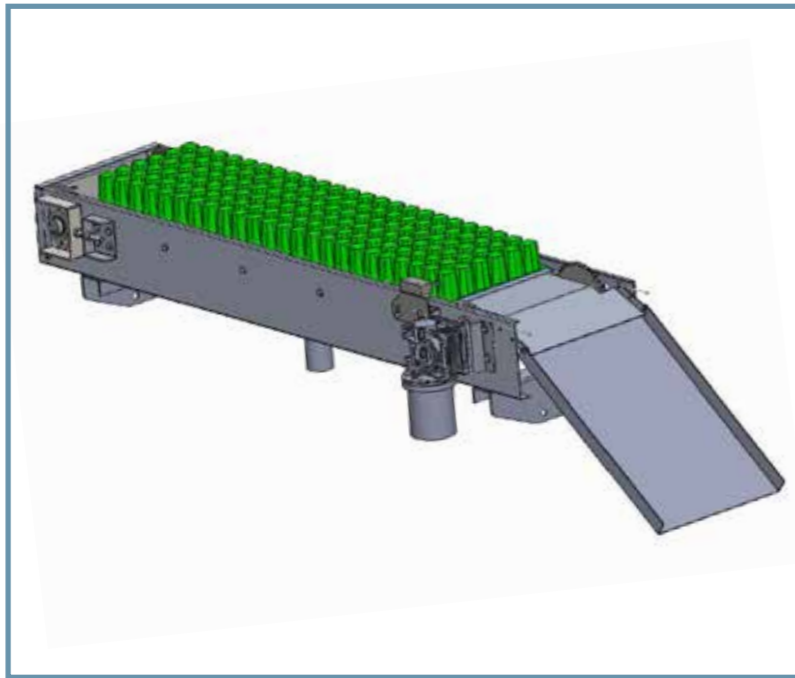

Distributor Motor off Warning Automatic Sowing System

Distributor Motor Off Warning: It is the system that informs that the electric motor that distributes the seeds to the feet is turned off. The system warns the operator visually and audibly.



Automatic Sowing System: It provides automatic sowing by programming the machine according to the trial pattern. The system is programmed by entering the number of rows, parcel numbers, parcel length, and spacing. The machine automatically makes the whole planting. No operator errors and no seed mixtures.

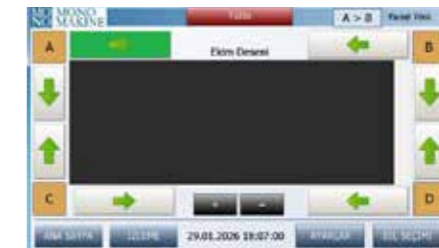

Barcode Sowing System: Seed preparation is done in the workshop. Trial pattern is uploaded to the machine system via flash memory. The barcode attached to the seed packages is read by the reader on the machine. The machine compares the test pattern with the barcode on the seed. If it is true, it will sow, if it is wrong, it will stop. It prevents seed mixes and improper seeding. Sowing while the dates, hours and humidity information is recorded and reported as can excell table.



OPTION LIST

Modular Chassis Structure	Std
Three-Point Tractor Mounted	Std
Adjustable Wheel Base	Std
30 Stage Planting Length	Std
60 Stage Planting Length	Opt
Electronic Control Planting Length	Opt
Fully Removable Planting Sys.	Std
Axe Feet Planting System	Std
Double Disk Planting System	Opt
Double Distributor System	Opt
Manual Control	Std
Manual Slope Setting	Std
Automatic Slope Setting	Opt
Second Operator Seat	Opt
Fertilizer Carriage Platform	Opt
Rear Closer Wheels	Std

* STD:Standard / OPT: Optional

TECHNICAL SPECIFICATIONS

SYSTEM	STANDARD	OPTION
Engine	Standard Diesel 21 Kw Water Cooled	--
Number of Planting Rows	6	2-4-8
Width of Planting	Row Min: 120 mm Max : 700 mm for 4 rows	2 Rows 120-1350 mm 4 Rows 120-900 mm 8 Rows 120-385 mm
Planting Length Increment Rate	160-560 Variable increment rate at each gear	--
Number of gears	30	--
Planting Length	1828- 11.513 mm	2.000 mm 32.000 mm
Distributor Max Working slope	±2°	±15°
Max. Planting Depth (Shoe opener)	80 mm	--
Max. Planting Depth (Single Disk Opener)	100 mm	--
Max. Planting Depth (Double Disk Opener)	100 mm	--
Min. Wheel Track Width	1050 mm	750 mm
Max. Wheel Track Width	1750 mm	2500 mm



DIMENSIONS

	STANDARD
Weight	650 Kg
Width	1750 mm
Length	1650 mm
Height	1800 mm
Tire Sizes	7,50-16

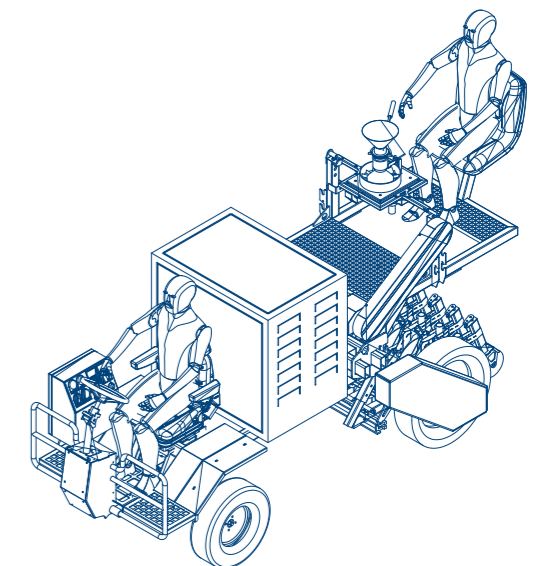

SELF PROPELLED SEEDER SPS

MONO

İvedik OSB Mahallesi 2265 Cadde No:30-32
Yenimahalle / ANKARA

☎ : +90 312 386 26 12

☎ : +90 312 386 26 13

🌐 : www.monomakine.com

✉ : info@monomakine.com

YouTube : www.youtube.com/user/monomakine1

facebook : [monomakine1](https://www.facebook.com/monomakine1)

