



PLOT SEEDER

**MO
NO**
MAKİNE



The importance of food safety and supply is increasing every passing day. Seed Improvement works are the foremost in important elements for supplying more quality and cheaper foods to its own people by efficient use of Nation's lands.

MONO MAKİNE continues to manufacture improvement tools and equipment in accordance with the recommendations and suggestions of people working in the field. Presents the state of the art possibilities with an innovative outlook by research to meet the needs of the industry. Planting Machinery, Threshing Machinery and Laboratory Machinery used in the seed improvement are MONO MAKİNE continues its R&D activities and manufactures manufactured completely by our company.

Tools and equipment in accordance with the requests of customers. Lowering the foreign dependence in the industry and ensuring the capital stays within borders is our most important value. Our aim is to become a worldwide recognized and industry-leading and followed manufacturer.

MONO MAKİNA İTH. İHR. TİC. SAN. LTD. ŞTİ.

INDEX

CHASSIS
DISTRIBUTORS
OPENERS
ELECTRONIC SYSTEMS
OPTION LIST
TECHNICAL SPECIFICATIONS

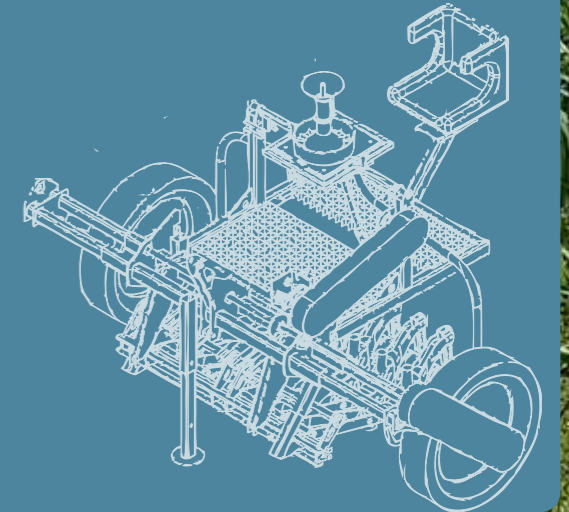



CHASSIS:

The machine is produced with steel sheets and profiles. All systems are produced modularly. Later, all parts can be replaced or new parts can be ordered. Machine track width can be adjusted. The sub-carrier system is produced in 3 different lengths. Opener shoes can be combined with 4-6-8. Row spacing can be adjusted. It is infinitely adjusted between 14-30 cm in 6 rows and 14-70 cm in 4 rows. It is produced as single seat as standard. If desired, an assistant operator seat can be installed.

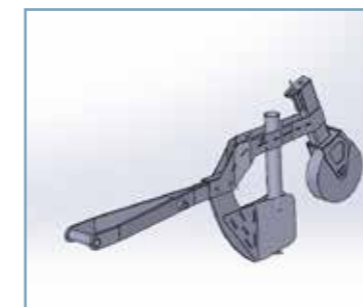

Shoe Opener

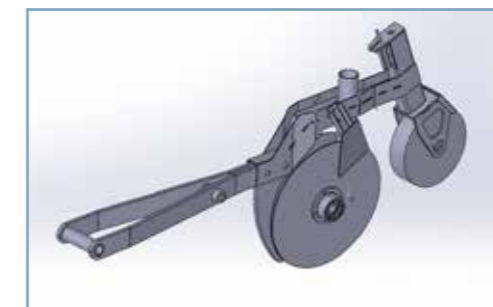

Double Disc Opener

OPENER TYPES:

Shoe Opener: It is made of 10 mm material and the wear zone is hardened. Sowing is precisely adjusted up to 10 cm with plastic wheels at the rear.

Double Disc Opener: It is produced with two angled discs of 33 cm in diameter. In addition, the wear zone is made of 10 mm sheet metal and the wear zone is hardened. Sowing is precisely adjusted up to 10 cm with plastic wheels at the rear.

Fertilizer Opener: Used with fertilizer distributor.

All openers can be ordered with mechanical or hydraulic lift.

PLOT SEEDER

Plot Seeder Specially produced machines for seed breeding. It is designed to be used in the most efficient way, in consultation with seed developers and people working in seed breeding.

MONO MAKINE Plot Seeder produces 4-6-8 rows starting from a single row machine. In addition, options can be added to be used in different products.

Electronic equipment can be added to provide ease of use and increase the sensitivity of planting.

Like all our machines, it is produced using high quality equipment and spare parts in order to be used for many years.



DISTRIBUTORS:

You can order the parcel seed drill with 4 different distributors. All distributors types can be used with automatic seeding system.

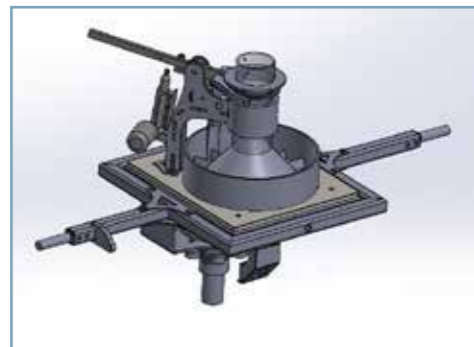

Mechanical Distributor: It is produced with a diameter of 275 mm as standard. It is suitable for plants with a seed size greater than 2 mm. It is produced from aluminum casting and coated with hard anodized. There is a 10-year warranty against wear. It is the most suitable distributor type for cereals because it does not require maintenance. Its parallelism to the ground plane can be adjusted laterally and vertically.

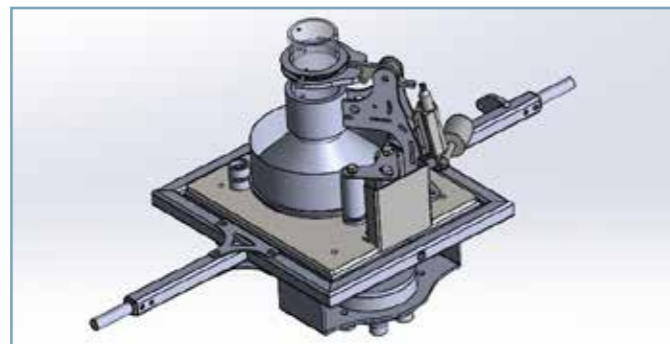

Belt Cone distributor: Made of aluminum solid material with a diameter of 225 mm. It is hard anodized. The seed conveyor belt is made of PVC material. Since it is suitable for all types of seeds, it is suitable for researchers working with different seeds. PVC tape needs to be maintained and replaced in fixed periods. Its parallelism to the ground plane can be adjusted laterally and vertically.



Double Distributor For Fertilizer And Seed: It is a system in which two distributors are mounted for fertilizer efficiency trials. It consists of two mechanical or Belt Cone distributors. Mechanical dispensers 275 mm in diameter, band dispensers are manufactured from aluminum with a diameter of 198 mm. It is hard anodized. Its parallelism to the ground plane can be adjusted laterally and vertically.

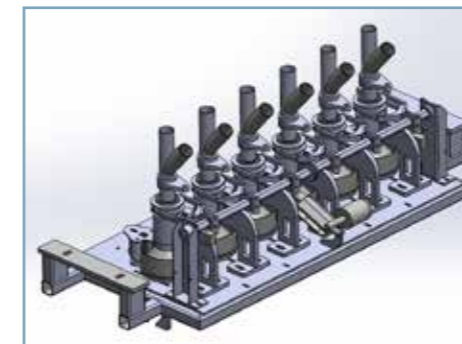

Multiple Distributor: It is used to sow different seeds in each row. It is made of 6 pieces of 110mm diameter solid aluminum material. It is used individually or with the magazine ear sowing system.



ELECTRONIC SYSTEMS:

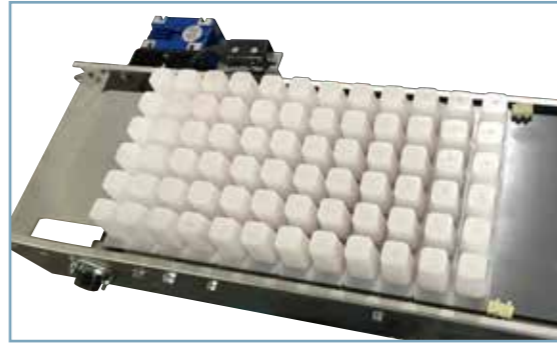
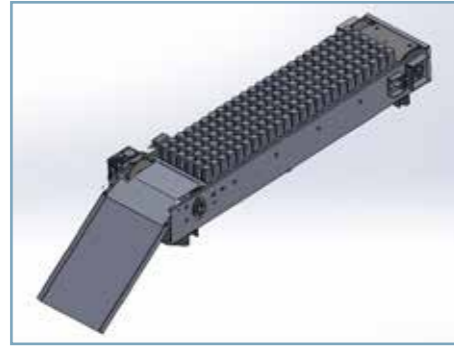

Automatic Magazine Ear Sowing: It is used to automatically sow 6 different seeds at the same time. It is used with multiple distributors and electronic control system. It is used with special 12 hole seed case and seed carrying plates made of 3 mm PVC. 1 carrier plate is required for every 10 piece special 12 hole seed case.

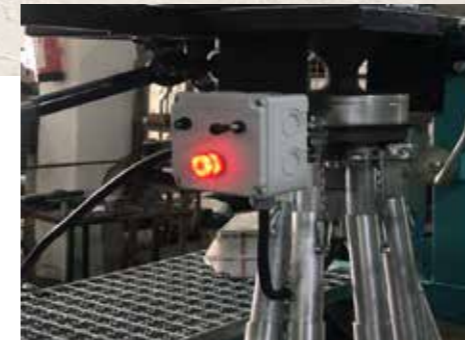

Distributor Motor off Warning



Automatic Sowing System

Distributor Motor Off Warning: It is the system that informs that the electric motor that distributes the seeds to the feet is turned off. The system warns the operator visually and audibly.

Automatic Sowing System: It provides automatic sowing by programming the machine according to the trial pattern. The system is programmed by entering the number of rows, parcel numbers, parcel length, and spacing. The machine automatically makes the whole planting. No operator errors and no seed mixtures.



Barcode Sowing System: Seed preparation is done in the workshop. Trial pattern is uploaded to the machine system via flash memory. The barcode attached to the seed packages is read by the reader on the machine. The machine compares the test pattern with the barcode on the seed. If it is true, it will sow, if it is wrong, it will stop. It prevents seed mixes and improper seeding. Sowing while the dates, hours and humidity information is recorded and reported as can excell table.



TECHNICAL SPECIFICATIONS

SYSTEM	STANDARD	OPTION
Number of Planting Rows	6	2-4-8
Width of Planting Row	Min: 140 mm Max : 700 mm for 4 rows	--
Planting Length Increment Rate	160-560 Variable increment rate at each gear	--
Number of gears	30	--
Planting Length	1828- 11.513 mm	Adjustable as per order
Distributor Max Working slope	±2°	±15°
Max. Planting Depth (Shoe opener)	80 mm	--
Max. Planting Depth (Single Disk Opener)	100 mm	--
Max. Planting Depth (Double Disk Opener)	100 mm	--
Min. Wheel Track Width	1050 mm	750 mm
Max. Wheel Track Width	1750 mm	2500 mm

OPTION LIST

Modular Chassis Structure	Std
Three-Point Tractor Mounted	Std
Adjustable Wheel Base	Std
30 Stage Planting Length	Std
60 Stage Planting Length	Opt
Electronic Control Planting Length	Opt
Fully Removable Planting Sys.	Std
Axe Feet Planting System	Std
Double Disk Planting System	Opt
Double Distributor System	Opt
Manual Control	Std
Manual Slope Setting	Std
Automatic Slope Setting	Opt
Second Operator Seat	Opt
Fertilizer Carriage Platform	Opt
Rear Closer Wheels	Std

* STD:Standard / OPT: Optional



DIMENSIONS

	STANDARD
Weight	650 Kg
Width	1750 mm
Length	1650 mm
Height	1800 mm
Tire Sizes	7,50-16

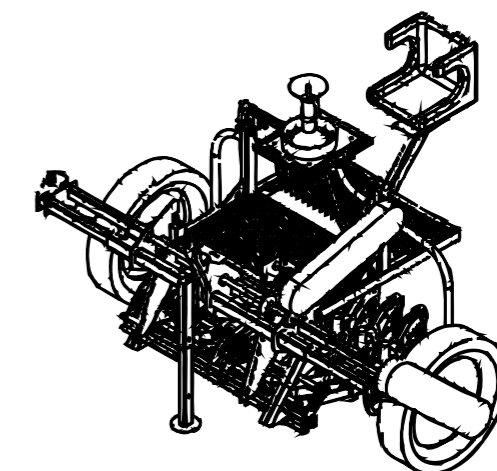

Field Research Equipment

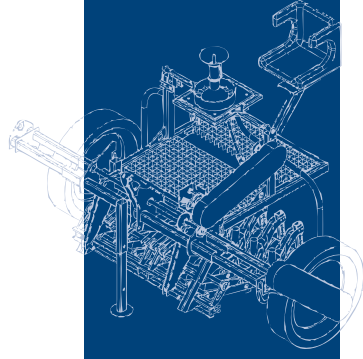

**MONO
MAKİNE**

MONO MAKİNA İTH. İHR. TİC. SAN. LTD. ŞTİ.

İvedik OSB Mahallesi 2265. Cadde, No: 30-32,
Ostim - Yenimahalle / ANKARA

☎ : +90 312 386 26 12

☎ : +90 312 386 26 13

🌐 : www.monomakine.com

✉ : info@monomakine.com

YouTube : www.youtube.com/user/monomakine1

facebook : [monomakine1](https://www.facebook.com/monomakine1)

